



# 8400EAF, 2.3EHAF, 3.1EAF, & 3.3EHAF

## Pond Aerator

8400EAF: 2HP, 220V, 50Hz Single Phase

2.3EHAF: 2HP, 380V, 50Hz, 3 Phase

3.1EAF: 3HP, 220V, 50Hz, Single Phase

3.3EHAF: 3HP, 380V, 50Hz, 3 Phase



### Quick Facts

- ⇒ 8400EAF & 3.1EAF Operate on 208-240V Single Phase Power
- ⇒ 2.3EHAF & 3.3EHAF Operate on 380V, 3 Phase Power
- ⇒ Complete Package includes Assembled Motor Unit, UV Resistant High Density Thermoplastic Float, Three 15m Braided Nylon Mooring Lines, and Rubber 1m Stub Cord
- ⇒ 2HP Operates in 51cm of Water; 3HP Operates in 61cm of Water
- ⇒ CE Marked
- ⇒ Sacrificial Anode Installed for Corrosion Protection and use in Salt Water Applications
- ⇒ Series 300 Austenitic Stainless Steel Construction of Exposed Metal; Salt Water Compatible
- ⇒ 2 Year Warranty
- ⇒ UPS Shippable
- ⇒ Energy Efficient with Excellent GPM/kW Rates
- ⇒ Industrial Strength Design
- ⇒ Top Intake for Shallow Water Operation
- ⇒ Optional Bottom Screen with 84 Vertical Screening Bars with Less Than 2.54cm Gaps to Keep Debris Out and Allow for Maximum Water Flow Into the Unit

Pond Aerators Produce a Crown of Water at the Surface

### Operation

- ⇒ Submersed motor with top intake pushes the water into the air using an open propeller design.
- ⇒ Individual water droplets absorb oxygen from the atmosphere and return to the body of water transferring oxygen from the air and into the water.
- ⇒ Moving water mixes and agitates the water, spreading oxygenated water throughout the body of water.
- ⇒ Single open propeller design allows for greater water flow with a lower likelihood of clogging and smaller water droplets to increase total surface area for oxygen transfer.
- ⇒ Coated stainless steel cage or propeller guard shall catch large debris and assist in reducing the likelihood of clogging while allowing for maximum water flow into the unit.

### Features

#### Motor Unit

- ⇒ 2HP & 3HP, 208-240V, Single Phase
- ⇒ 2HP & 3HP, 380V, 3 Phase
- ⇒ 1450 RPM Motor
- ⇒ Oil Cooled, Continuous Duty Rated Motor
- ⇒ Two Long Life Bearings
- ⇒ Thermal Overload Protection
- ⇒ Fully Unitized Heavy Duty Silicon Carbide Mechanical Seal
- ⇒ Series 300 Austenitic Stainless Housing with Engineering Grade Thermoplastic Top
- ⇒ Protective Coated Series 300 Austenitic Stainless Steel Cage/Prop Guard with 18 Vertical Bars and 3.8cm Spacing
- ⇒ UV Resistant Engineered Thermoplastic Propeller with All Blades on the Same Plane

#### Power Cable

- ⇒ 1m Stub Cord
- ⇒ Rubber Jacket, 3 Conductor Power Cord with Earth Conductor
- ⇒ Potted Quick Disconnect and Stainless Steel Strain Relief Standard
- ⇒ Flex Sleeve Cord Protection

#### Float

- ⇒ U.V. Resistant High Density Thermoplastic
- ⇒ 3-Piece Lap Joint Float
- ⇒ Protective Coated Series 300 Stainless Steel Hardware
- ⇒ Three 15m Braided Nylon Mooring Ropes

#### Optional Bottom Screen

- ⇒ Protective Coated Stainless Steel
- ⇒ 84 Vertical Screening Bars w/ Gaps Tapered from 222mm to 48mm on Bottom Screen
- ⇒ 19cm H x 58.4cm Tapering to 21cm Diameter
- ⇒ Series 300 Stainless Steel Attachment Clips

# Kasco 8400EAF, 2.3EHAF, 3.1EAF, & 3.3EHAF Specifications

Model #	HP	Cord Length	Watts	Voltage/Phase/Hz	Running Amps	Lock Rotor Amps	Sugg. Pond Size*	Min. Depth of Operation	Shipping Weight	Number of Boxes
8400EAF000	2	Stub	1,760	220/1/50	8	40	8,000m <sup>2</sup>	51cm	46.5 kg	2
2.3EHAF000	2	Stub	1,702	380/3/50	2.6	12	8,000m <sup>2</sup>	51cm	48.5 kg	2
3.1EAF000	3	Stub	2,618	220/1/50	11.9	59	12,000m <sup>2</sup>	61cm	54 kg.	2
3.3EHAF000	3	Stub	2,698	380/3/50	4.1	20	12,000m <sup>2</sup>	61cm	56 kg.	2

\* Pond Size is determined by multiplying length x width of the pond. The actual shape, depth, and oxygen demand should be considered when selecting a unit size.

## Use Warnings

- Max Water Temp of 35°C
- For Use in Non-Explosive Areas Only
- Use to Pump Water Only
  - Non-Flammable
  - Non-Toxic
  - Non-Corrosive (salt water is acceptable)
- Do Not Run the Unit Dry
- Discontinue use and remove when water is below 0°C.
- RCD (residual current device) or GFCI (ground fault circuit interrupter) protected circuit required



Optional coated stainless steel bottom screen helps protect the unit from debris. The bottom screen has 84 vertical bars with gaps less than 2.54cm.

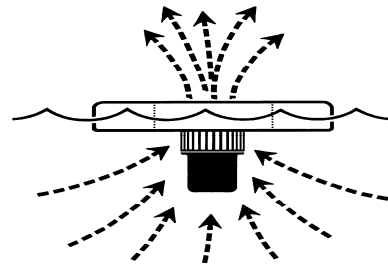

During unit operation, water is circulated from 360° around the unit as well as from below. Top intake for shallow water operation.

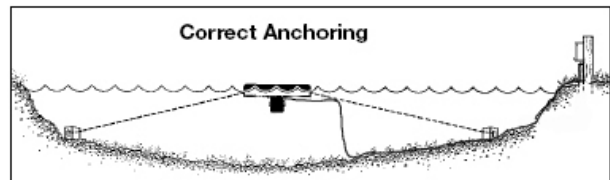

Assembly and Installation of Kasco equipment is quick and easy. Each unit includes an Owners Manual with specific steps to assemble, install, and operate the equipment properly.

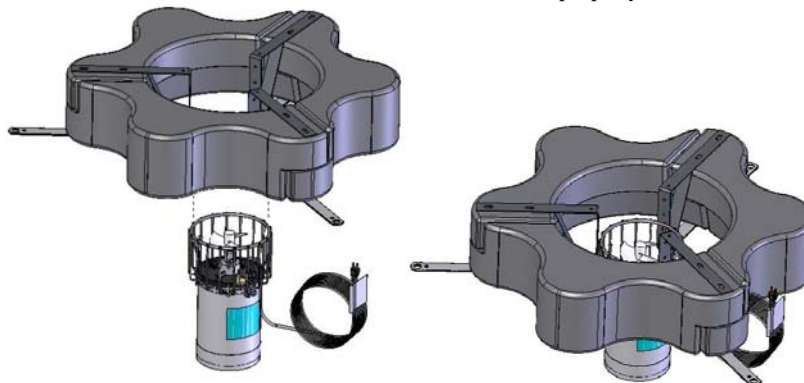

The motor unit attaches to the float using stainless steel hardware for a secure assembly. The 3 section, U.V. resistant, high density thermoplastic float allows for excellent durability with an attractive shape and low visibility.

Kasco Marine, Inc.  
800 Deere Rd.  
Prescott, WI 54021

Ph: (715) 262-4488 \* Fax: (715) 262-4487  
[www.KascoMarine.com](http://www.KascoMarine.com) \* [www.GotAlgae.com](http://www.GotAlgae.com)  
Sales@KascoMarine.com



Rev. 2/3/11